

Závitové tvarovky RA

z pozinkované oceli

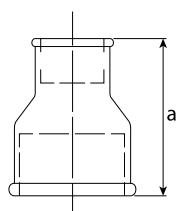

Redukovaná hrdla RA240 s vnitřními závity			
Obj. č.	Vnitřní závit 1	Vnitřní závit 2	a
RA240-3812	Rp 3/8"	Rp 1/2"	36
RA240-3834	Rp 3/8"	Rp 3/4"	39
RA240-1234	Rp 1/2"	Rp 3/4"	39
RA240-1210	Rp 1/2"	Rp 1"	45
RA240-3410	Rp 3/4"	Rp 1"	45
RA240-1254	Rp 1/2"	Rp 1 1/4"	50
RA240-3454	Rp 3/4"	Rp 1 1/4"	50
RA240-1054	Rp 1"	Rp 1 1/4"	50
RA240-3415	Rp 3/4"	Rp 1 1/2"	55
RA240-1015	Rp 1"	Rp 1 1/2"	55
RA240-5415	Rp 1 1/4"	Rp 1 1/2"	55
RA240-1220	Rp 1/2"	Rp 2"	65
RA240-3420	Rp 3/4"	Rp 2"	65
RA240-1020	Rp 1"	Rp 2"	65
RA240-5420	Rp 1 1/4"	Rp 2"	74
RA240-1520	Rp 1 1/2"	Rp 2"	74
RA240-1025	Rp 1"	Rp 2 1/2"	74
RA240-5425	Rp 1 1/4"	Rp 2 1/2"	74
RA240-1525	Rp 1 1/2"	Rp 2 1/2"	74
RA240-2025	Rp 2"	Rp 2 1/2"	74
RA240-2030	Rp 2"	Rp 3"	80
RA240-2530	Rp 2 1/2"	Rp 3"	80
RA240-2040	Rp 2"	Rp 4"	94
RA240-2540	Rp 2 1/2"	Rp 4"	94
RA240-3040	Rp 3"	Rp 4"	94

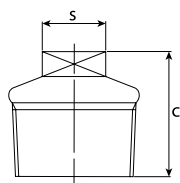

Záslepky RA290 s vnějším závitem			
Obj. č.	Závit	c	s
RA290-38	R 3/8"	24	14
RA290-12	R 1/2"	26	18
RA290-34	R 3/4"	32	20
RA290-10	R 1"	36	23
RA290-54	R 1 1/4"	39	23
RA290-15	R 1 1/2"	41	28
RA290-20	R 2"	48	33
RA290-25	R 2 1/2"	54	32
RA290-30	R 3"	60	42
RA290-40	R 4"	70	41



Záslepky RA300 s vnitřním závitem		
Obj. č.	Závit	a
RA300-38	Rp 3/8"	17
RA300-12	Rp 1/2"	19
RA300-34	Rp 3/4"	22
RA300-10	Rp 1"	24
RA300-54	Rp 1 1/4"	27
RA300-15	Rp 1 1/2"	27
RA300-20	Rp 2"	32
RA300-25	Rp 2 1/2"	35
RA300-30	Rp 3"	38
RA300-40	Rp 4"	45